

BUILDING LAYOUT

Not to Scale.
Room numbers are in bold

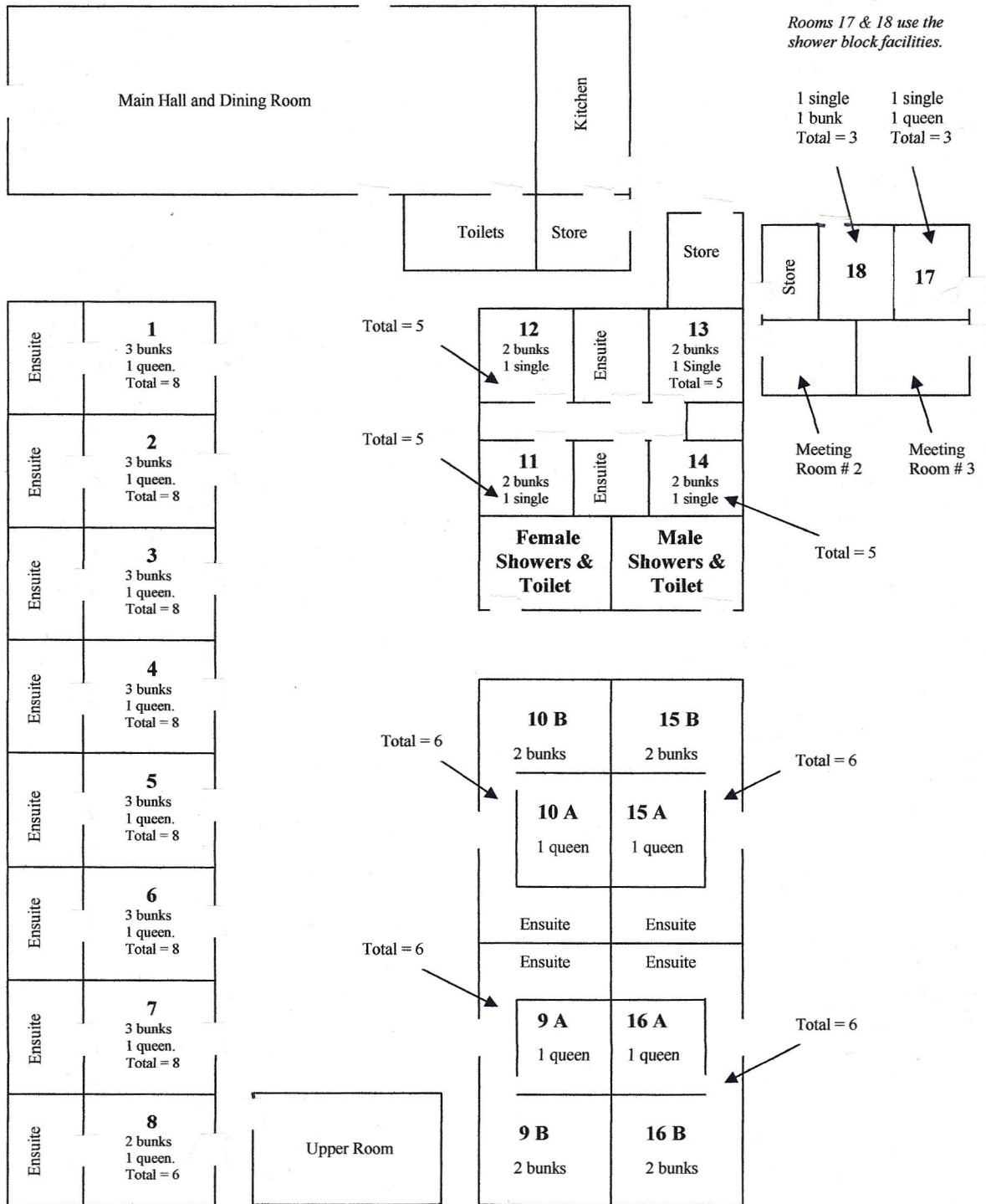

PLEASE NOTE: You are entitled to 1 room for every 4 people you have. You may however pay for extra rooms if required.

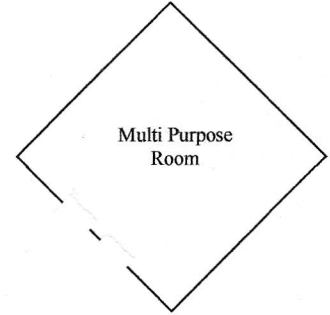

Ensuite	1 3 bunks 1 queen. Total = 8
Ensuite	2 3 bunks 1 queen. Total = 8
Ensuite	3 3 bunks 1 queen. Total = 8
Ensuite	4 3 bunks 1 queen. Total = 8
Ensuite	5 3 bunks 1 queen. Total = 8
Ensuite	6 3 bunks 1 queen. Total = 8
Ensuite	7 3 bunks 1 queen. Total = 8
Ensuite	8 2 bunks 1 queen. Total = 6

NOTE:
Room 8 is suitable for people with disabilities